

FANUC Robot P-40iA



FEATURES

- The FANUC P-40iA Robot is a mid-size paint robot with a 5kg payload capacity.
- It can be used in Zone 1 hazardous areas due to its high Equipment Protection Level Gb rating.
- The P-40iA's slim and compact body, small footprint and various mounting capabilities (floor, invert, angle mount) enables flexible layouts and a compact spray booth.
- The explosion protected purged motor box (option) simplifies the engineering of explosion protected robot peripherals such as rails or fixture rotators.
- Offline programming with FANUC's process focused PaintPro Software in ROBOGUIDE (option) drastically reduces programming time - saving time and engineering costs.

Application Example

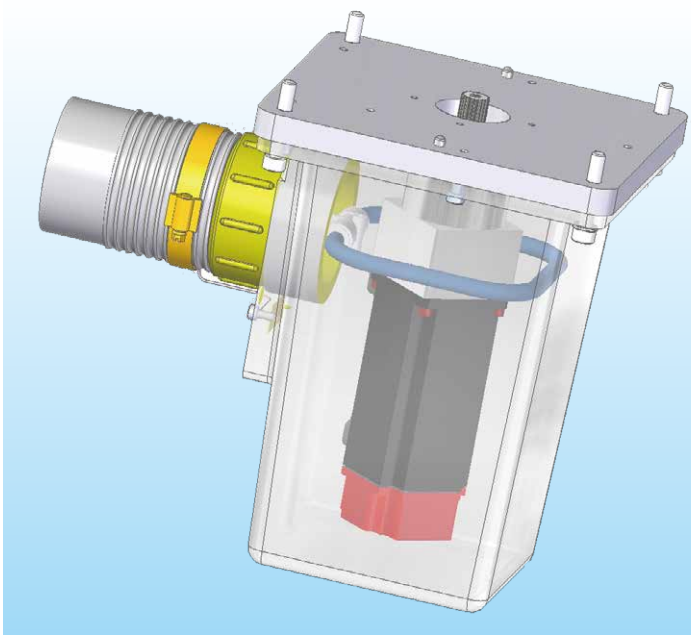

Explosion protected purged motor box (option)



Small part painting

Operating space

P-40iA

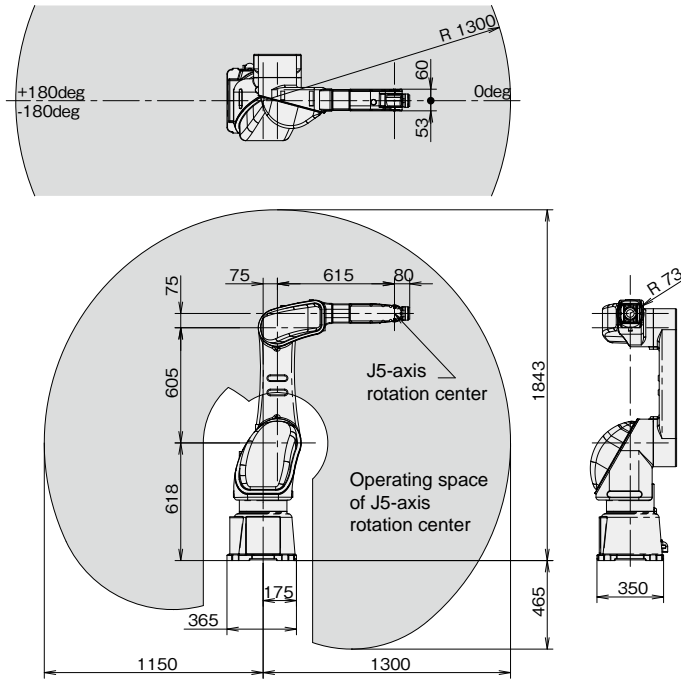

Specifications

Model		P-40iA	
Type		Articulated Type	
Controlled axes		6 axes (J1,J2,J3,J4,J5,J6)	
Reach		1300 mm	
Installation Note 1)		Floor, Upside-down, Wall, Angle mount	
Motion range (Maximum speed) Note 2)	J1 axis rotation	360° (220°/s)	6.28 rad (3.84 rad/s)
	J2 axis rotation	255° (190°/s)	4.45 rad (3.32 rad/s)
	J3 axis rotation	423° (240°/s)	7.38 rad (4.19 rad/s)
	J4 axis wrist rotation	380° (450°/s)	6.63 rad (7.85 rad/s)
	J5 axis wrist swing	240° (450°/s)	4.19 rad (7.85 rad/s)
	J6 axis wrist rotation	720° (720°/s)	12.57 rad (12.57 rad/s)
Max. load capacity at wrist		5 kg	
Max. load capacity on outer arm		1 kg	
Max. load capacity on inner arm		1 kg	
Allowable load moment at wrist	J4 axis	11.9 N·m	1.21 kgf·m
	J5 axis	11.9 N·m	1.21 kgf·m
	J6 axis	6.7 N·m	0.68 kgf·m
Allowable load inertia at wrist	J4 axis	0.3 kg·m ²	3.06 kgf·cm·s ²
	J5 axis	0.3 kg·m ²	3.06 kgf·cm·s ²
	J6 axis	0.1 kg·m ²	1.02 kgf·cm·s ²
Drive method		Electric servo drive by AC servo motor	
Repeatability		± 0.03 mm	
Mass Note 3)		110 kg	
Explosion protection rating		pxb ib IIB T4 Gb (Gas) (Japan) Class I, II, III Div. I Group C, D, E, F, G T4 (Gas, Dust) (US) II 2 G c Ex ib px IIB T4 Gb (Gas) (EU) II 2 D c Ex ib p IIIB T135°C Db (Dust) (EU)	
Installation environment		Ambient temperature : 0 – 45°C Ambient humidity : Normally 75 %RH or less (No dew, nor frost allowed) Short term Max. 95 %RH or less (within one month) Vibration acceleration : 4.9 m/s ² (0.5G) or less	

Note 1) Motion range is restricted in case of the wall or angle mounting.

Note 2) During short distance motions, the axis speed may not reach the maximum value stated.

Note 3) Without controller.

FANUC CORPORATION

Headquarters Oshino-mura, Yamanashi 401-0597, Japan

Phone: 81-555-84-5555 Fax: 81-555-84-5512 <https://www.fanuc.co.jp>

Overseas Affiliated Companies

FANUC America Corporation
FANUC Europe Corporation, S.A.
SHANGHAI-FANUC Robotics CO., LTD.
KOREA FANUC CORPORATION
TAIWAN FANUC CORPORATION
FANUC INDIA PRIVATE LIMITED
FANUC SINGAPORE PTE. LTD.
FANUC THAI LIMITED
FANUC MECHATRONICS (MALAYSIA) SDN. BHD.
PT. FANUC INDONESIA
FANUC OCEANIA PTY. LIMITED
FANUC SOUTH AFRICA (PROPRIETARY) LIMITED

3900 West Hamlin Road, Rochester Hills, MI 48309-3253, U.S.A.
7, rue Benedikt Zender, L-6468 Echternach, Grand-Duché de Luxembourg
No. 1500 Fuliian Road, Baoshan Area, Shanghai, China
101, Wanam-ro(st), Seongsan-gu, Changwon-si, Gyongsangnam-do, 642-290 Republic of Korea
No.10, 16th Road, Taichung Industrial Park, Taichung, Taiwan
41-A, Electronics City, Bangalore, 560 100, India
No.1 Teban Gardens Crescent, Singapore 608919, Singapore
1301 Pattanakarn Road, Kwaeng Suanluang, Khet Suanluang, Bangkok 10250 Thailand
No.32, Jalan Pengacara U1/48, Temasya Industrial Park, Section U1, Glenmarie, 40150 Shah Alam, Selangor Darul Ehsan, Malaysia
JL. Boulevard Bukit Gading Raya Blok R, Jakarta 14240 Indonesia
10 Healey Circuit, Huntingwood, NSW 2148, Australia
17 Loper Ave. Aeroport Industrial Ests. Spartan Ext.2 P.O.Box 219, Isando 1600, Republic of South Africa

Phone: 1-248-377-7000 Fax: 1-855-774-7051
Phone: 352-727777-1 Fax: 352-727777-403
Phone: 86-21-5032-7700 Fax: 86-21-5032-7711
Phone: 82-55-278-1200 Fax: 82-55-284-9826
Phone: 886-4-2359-0522 Fax: 886-4-2359-0771
Phone: 91-80-2852-0057 Fax: 91-80-2852-0051
Phone: 65-6567-8566 Fax: 65-6566-5937
Phone: 66-2-714-6111 Fax: 66-2-714-6120
Phone: 60-3-7628-0110 Fax: 60-3-7628-0220
Phone: 62-21-4584-7285 Fax: 62-21-4584-7288
Phone: 61-2-8822-4600 Fax: 61-2-8822-4666
Phone: 27-11-392-3610 Fax: 27-11-392-3615

● All specifications are subject to change without notice.
● No part of this catalog may be reproduced in any form.
● The products in this catalog are controlled based on Japan's 'Foreign Exchange and Foreign Trade Law'. The export from Japan may be subject to an export license by the government of Japan. Further, re-export to another country may be subject to the license of the government of the country from where the product is re-exported. Furthermore, the product may also be controlled by re-export regulations of the United States government. Should you wish to export or re-export these products, please contact FANUC for advice.

© FANUC CORPORATION, 2019

RP-40iA(E)-01, 2019.9, Printed in Japan